

Features

- UNIQUE FUNNEL HEAT SINK DESIGN
- HIGH PERFORMANCE MEANWELL DRIVER
- SAMSUNG SMD LEDS
- 90 LM/W
- 80W
- 7,200 LM
- IP65

Application

- WALL LIGHTING
- COMMERCIAL
- INDUSTRIAL
- WORKSHOP
- FACTORY
- STORAGRE

Certificate

- ETL(5001529), DLC

Warranty

- 5 Years warranty

Specifications

Model No.:	WP-100W
Power Consumption:	100W
Input Voltage:	100-277Vac
Operate Frequency:	50-60Hz
Lumens Output:	8000-9000lm
LED Brand:	SAMSUNG
Color Temperature:	3000K / 4000K / 5000 / 6000K
CRI:	Ra≥75
Beam Angle:	120°
IP Rated:	IP65
Power Factor:	>0.95
Total Harmonic Distortion:	<20%
Working Temp.:	-20°C ~ 50°C
Storage Temp.:	-40°C ~ 70°C
Lifespan L70(H):	>50,000 Hours
Cables:	0.3m three-core high quality silicon wire
Fixture Weight:	6.0Kg(13.2lb)



Unit: mm

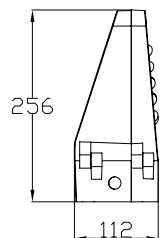
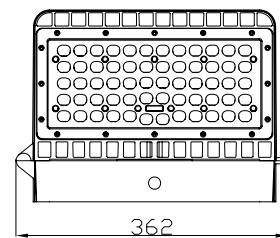

Product	Input Voltage	CCT	Housing color	Operation
WP03100W-50K	100-277Vac(Standard)	30K	Brown(Standard)	Non-dimming (Standard)
		3000 kelvin		
		40K		
		4000 Kelvin		
		50K		
5000 Kelvin				
60K				
6000 Kelvin				

Light Distribution Curve

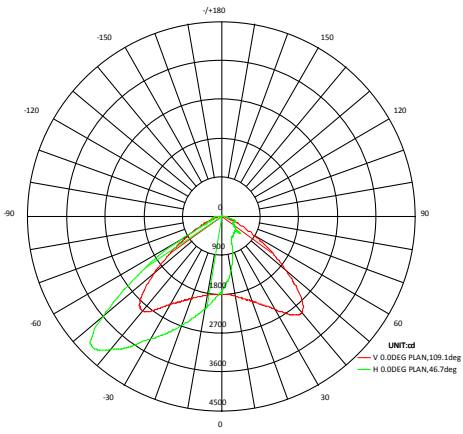

Illumination Distribution

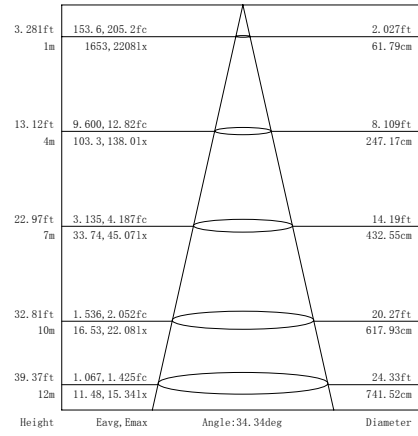

Warranty Policy

- Standard 5 years after purchase under normal usage