



Applications

- Parking lot
- Wall Pack
- Roadway
- Billboard

Certification

- CE
- VDE
- UL
- FCC
- DLC
- PSE
- TIS
- KC

Description

Easy Replace & Install
High Luminous Efficacy 125 lm/W
Wireless Lighting Control

Specifications

Model Name		WP050	
Power Consumption		50W	
Light source		0.2W Mid Power LED Chips (Qty : 192 pcs)	
Correlated Color Temperature		5000K (3500K / 4000K / 6500K available)	
Luminous Flux *		6,250 lm	
Luminous Efficacy *		125 lm/W	
LED Driving Current *		83.3 mA	
Color Rendering Index		80 Ra	
Light Distribution		Asymmetric Wide	
BUG Rating		B1 – UX – G1 (Backlight – Uplight – Glare)	
LED Chip Manufacturer		SAMSUNG	
Input Voltage		100 ~ 277 Vac	
Input Current		Max 0.6A (@100Vac)	
Power Factor		≥0.9 at Max load	
Frequency		50 / 60 Hz	
Driver Type		Constant Current (CC)	
Fixture & Driver Manufacturer		KMW INC. / Made in Korea	
Size (W x L x H)		15.4 x 9.5 x 4.4 (inch)	390 x 242 x 110.5 (mm)
Weight (Driver included)		7.1 lb	3.2 Kg
Material	Body	Cast Aluminum	
	Optic	Silver Coating Reflector	
	Cover	Tempered Glass 3.2T (Clear)	
Finish		Powder Coating	
IP Rating	IK Rating	IP66	IK07
Mounting Option		Wall Mount, Mount Bracket, Pole Mount	
Operating Temperature		-22°F ~ 140°F	-30°C ~ 60°C
Life Time		50,000 Hours (@77°F / 25°C)	
Warranty		5 Years (12 hours usage per day)	
Option			
Control System		Wireless (ZigBee) / Sensor (Daylight)	
Surge Protection		Line-Line 20KV, Line-FG 20KV	

*Tolerance : ± 5%

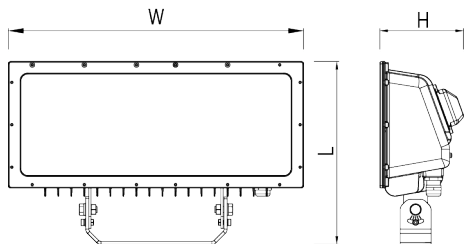

Mount Bracket Type

Photometry

See photometric .ies files for details.

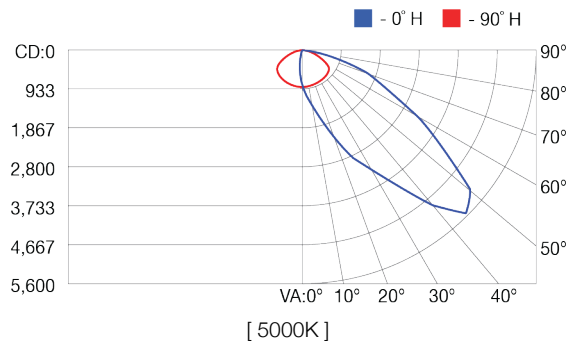

Control Specification (Optional)

ZigBee		Wireless Control
Input Voltage	15 Vdc	
Max. Power Consumption	0.3 W (@15Vdc)	
Standard	2.4 GHz - IEEE 802.15.4 (Compatible)	
Network	Mesh	
RF Tx Power	Max. +8 dBm (Typ. 5 dBm)	
Data Rate	250 kbps	
Security	128 bit AES Encryption Algorithms	
Dimmer	PWM, 0 – 10 Vdc	
Antenna	Omni Type, 2 dBi	
Daylight Sensor		
Operating Voltage Range	5 Vdc (MAX. 6 Vdc)	
Max. Power Consumption	40 mW (@5Vdc)	
Detectable Illumination Range	9.2 – 92 fc (Default : 64 fc) / 100 – 1,000 lx (Default : 700 lx)	
Output Signal	DC level	

Ordering Information

Order Code Usage : WP050-A50WMNG1S

WP	OOO	-	O	OO	OO	O	OO	O
	Power Consumption		Input Voltage	CCT (K)	Installation Type	Control System	Fixture Color	Surge Protector
	050=50W 075=75W 100=100W		A=100~277V B=100~240V	35=3500K 40=4000K 50=5000K 65=6500K	WM=Wall Mount MB=Mount Bracket PH=Pole Mount Horizontal PV=Pole Mount Vertical	A=Daylight Sensor Z=ZigBee N=None	G1=Gray Powder	S=Yes Black=No